

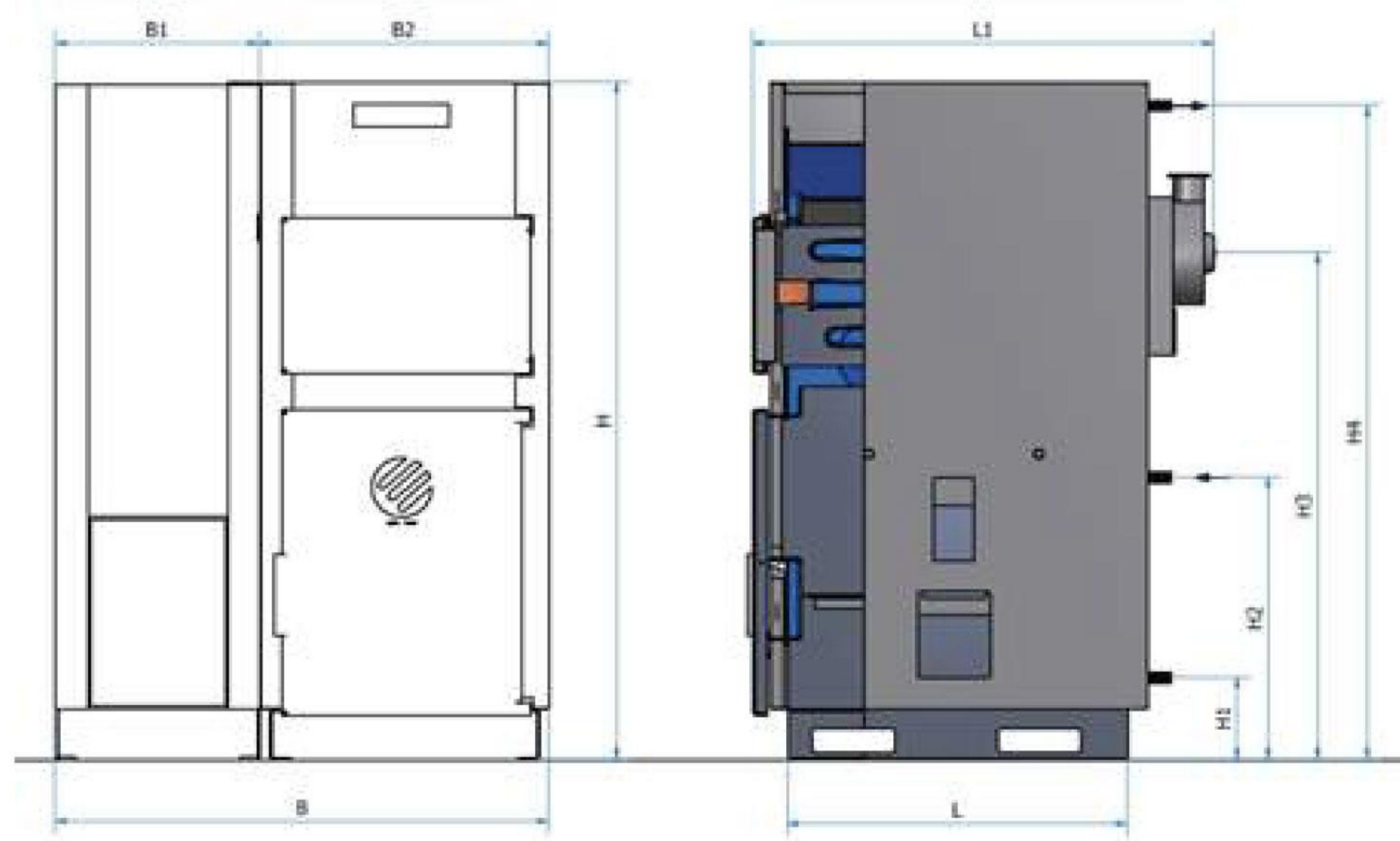

🇬🇧 *ECO EDP are pellet and wood heating boilers with an integrated pellet burner. There are three available models: EDP 35kw, 45kw and 65kw. The four-pass way design keeps pellet consumption low and ensures for high efficiency >92%. The boiler can be connected to a room thermostat and allows for daily and weekly programming. ECO EDP can be used with wood logs through using the firewood plate.*

### TECHNICAL SPECIFICATIONS



Parameters		EDP 35	EDP 45	EDP 65
Nominal Heating Output - Pelet	kw	35	45	65
Efficiency	%	93	93	93
Pellet Consumption	kg/h	2.50-7.50	3.00-9.60	4.00-14.00
Water Temperature	C	60-80	60-80	60-80
Electrical cons.(start-up)	w	150+450	150+450	150+450
Chimney	mm	120	120	120
Pellet Reservar	kg	150	160	180
Water Content	Lit.	64	94	115
Weight	kg	287	340	380

Dimensions	H (mm)	B <sub>1</sub> (mm)	B <sub>2</sub> (mm)	B (mm)	L <sub>1</sub> (mm)	L (mm)	H <sub>1</sub> (mm)	H <sub>2</sub> (mm)	H <sub>3</sub> (mm)	H <sub>4</sub> (mm)
EDP 35	1330	400	510	910	960	660	280	550	1330	1220
EDP 45	1330	400	560	960	1150	660	280	550	1330	1220
EDP 65	1330	400	610	1010	1210	725	280	550	1330	1220